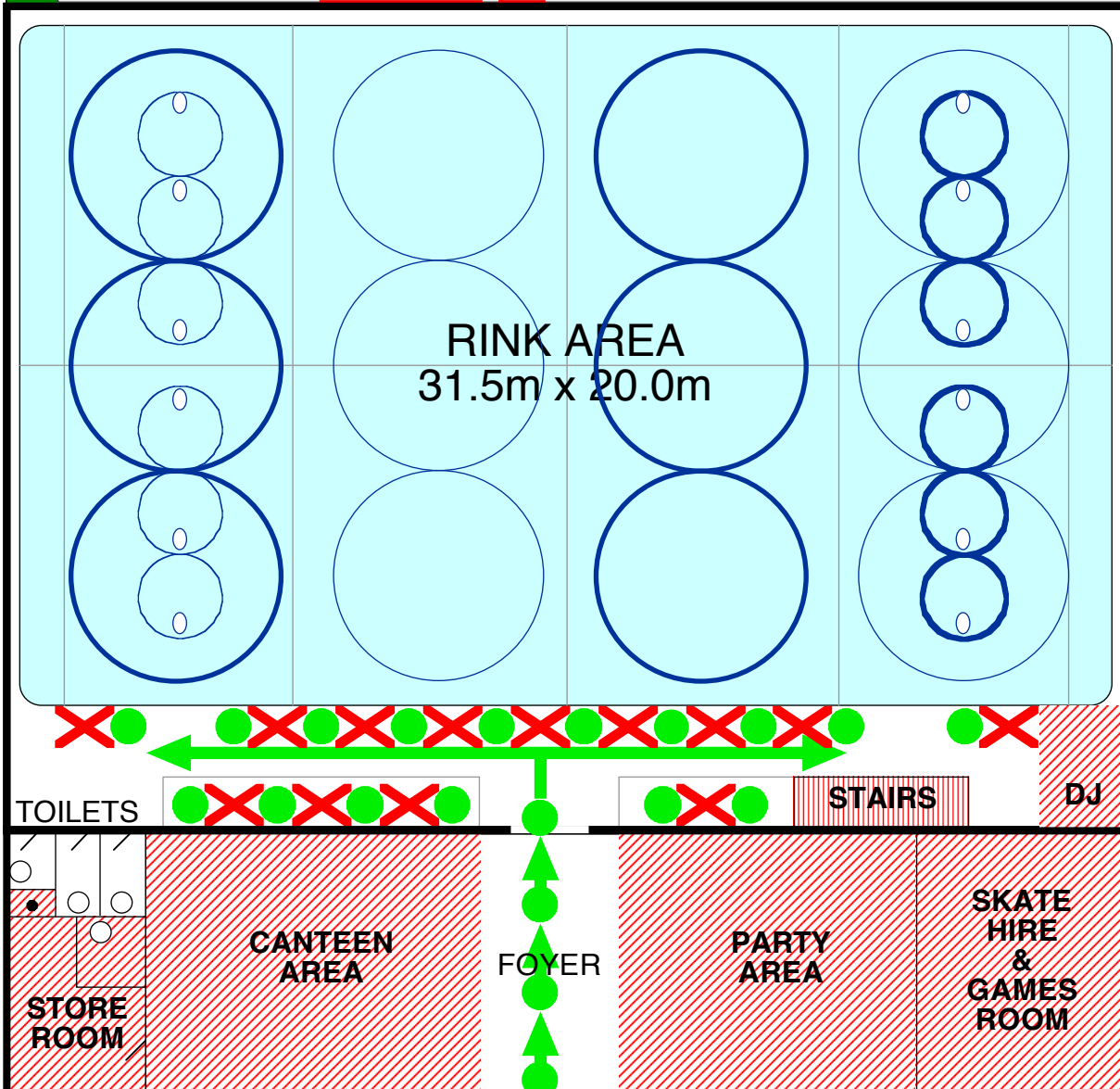

## REAR CAR PARK

PULLMAN  
PLACE  
ENTRY

**ON RINK SIZE:**  
630m<sup>2</sup>  
= 157.5 people

or

100 people  
= 6.3m<sup>2</sup>

**RINK ROOM:**  
752m2  
= 188 people

or

100 people  
= 7.52m<sup>2</sup>

**HIRE ROOM:**  
45m2  
= 11 people

**FOYER ROOM:**  
165m<sup>2</sup>  
= 41 people

## FRONT CAR PARK

RUSSELL  
STREET  
ENTRY